



ABB B21 Steel - Summary Sheet

This entry level single phase meter in the ABB B21 range is 2 modules wide and can be mounted on DIN Rail. Supporting up to a 65 Amp load this direct connect meter is MID approved meter, making it suitable for billing applications.

It has a host of available parameters to read, including Energy (kWh), Current (I), Voltage (V), Frequency (Hz), Power Factor (pf) and Active Power (W).

It features a Pulse Output as standard that can be used to log kWh readings or as an alarm (which is easily configurable on the meter) connected by a relay. In addition, Modbus or Mbus Output models are available which may be used to connect to a variety of BMS or EMS systems. It can also be used to communicate through the ABB G13 Ethernet Gateway for remote reading of a network of meters.

Specification

Meter Type	Single Phase
Fitting Type	DIN Rail
Max. Current (Amps)	65
MID Approved	Yes
Smart	No
Input Type	Direct Connect
Output Type	Pulse / Modbus / Mbus *
Tariffs	Single
Import / Export	Import Only
Module Width	2
Availability	See Model Variants

* Dependant on model selected

Model Variants

SPDABB211 *	Pulse Output
SPDABB212	Modbus & Pulse Output
SPDABB213	Mbus & Pulse Output

* Available next working day

Dimensions

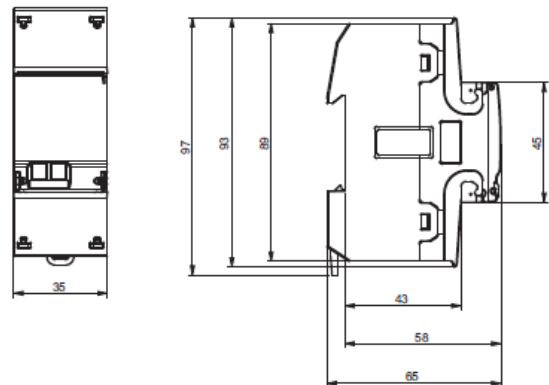

Wiring Diagram

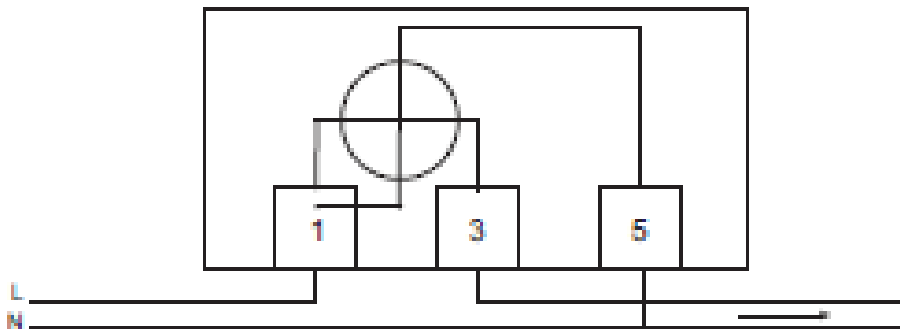

Web: www.spwales.com | Email: sales@spwales.com | Phone: 01803 295430 | Fax: 01803 212819

While Stephen P Wales Ltd has made every reasonable effort to ensure the accuracy of this information, Stephen P Wales Ltd does not guarantee that it is error-free, nor does Stephen P Wales Ltd make any other representation, warranty or guarantee that the information is accurate, correct, reliable or current. Stephen P Wales Ltd reserves the right to make any adjustments to the information contained herein at any time without notice.